

SERIES 2000 CLOVER & SERIES 2300 GRAZING VALVES

TECHNICAL DATA SHEET

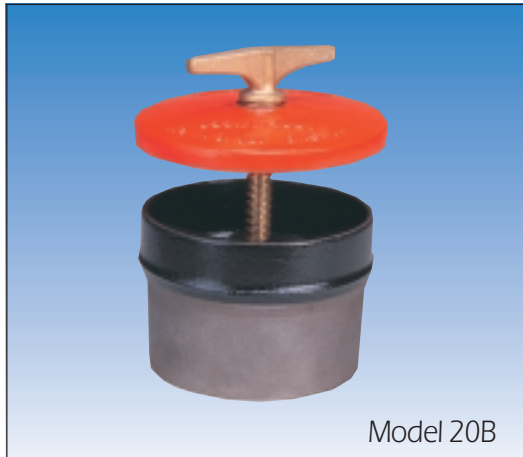

Series 2000 Clover Valves

Features

- FRESNO superior design and quality.
- Precision ground seat ensures watertight seal.
- Heavy-duty Cast Iron frame and cover for long life.
- Cast-in-place bronze bushing won't pull out.
- Brass screw is rugged and easy to operate.
- Tapered frame skirt assures excellent fit on plastic pipe model.

Applications

The Series 2000 Clover Valve is an overflow type valve designed for use in surface irrigation to provide reliable shut off and regulation of flow from underground pipelines to irrigation furrows or checks. The Series 2000 may also be used in conjunction with distributing pots in vineyard and orchard applications. Clover Valves also provide effective level control and aeration in ponds or as drains for sumps or stand pipes.



Series 2300 Grazing Valves

Features

- Non-protruding screw:
 - Protects against unauthorized valve resetting.
 - Eliminates stem damage by equipment or livestock.
 - Protects livestock from injury.
- Self-cleaning screwhead slots.
- Brass screw ensures smooth operation.

Applications

The Series 2300 Grazing Valve is used in the same applications as the Series 2000 Clover Valve. They differ in that the stem does not project above the cover. This feature reduces the chance of damage to the valve from livestock or other traffic. A brass tee handled key is required to open and close the valve. This makes the Grazing Valve cover assembly less susceptible to theft.

SPECIFICATIONS

SERIES 2000 CLOVER VALVE

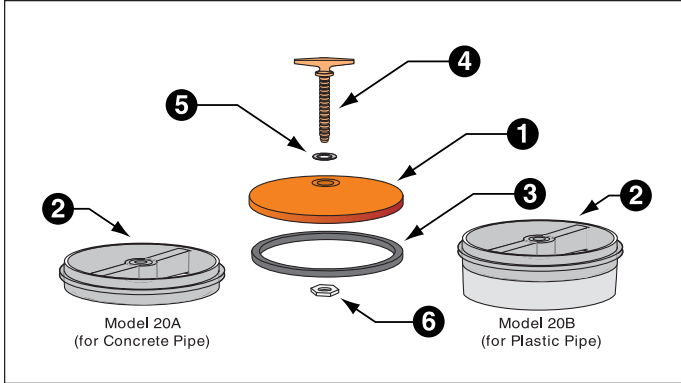

SERIES 2300 GRAZING VALVE

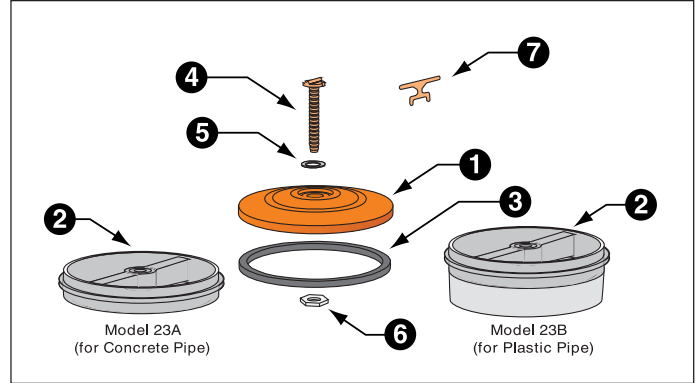

Material Specifications

| Item | Description | Material | Specification |
|------|-------------|--------------|--------------------|
| 1 | Cover (Lid) | Cast Iron | ASTM A126, Class B |
| 2 | Frame | Cast Iron | ASTM A126, Class B |
| 3 | Gasket | SBR | ASTM D2000 |
| 4 | Screw | Brass | ASTM B584, C83600 |
| 5 | Washer | Brass | ASTM B16 |
| 6 | Nut | Brass | ASTM B584, C84400 |
| 7* | Key | Mang. Bronze | ASTM B584, C86500 |

*Series 2300 Only

Installation

Series 2000 & 2300 Valves are designed for use with plastic pipe or concrete pipe. When used with plastic pipe the outside of the valve frame is joined to the inside of the plastic pipe with epoxy. Draw bands may be used to provide additional joint strength. When used with concrete pipe, valve frames are normally mortared to the end of the pipe or inside the end of a larger diameter pipe. Ready-set rings are available to hold the valve frame in place while being mortared.

Pressure Rating

Valve Sizes:

3" – 12" 50 ft. (22 psi max.)

14" – 20" 25 ft. (11 psi max.)

Options

- 6" – 14" available with Vee or Acme thread.
- Ready-set ring for easy installation.

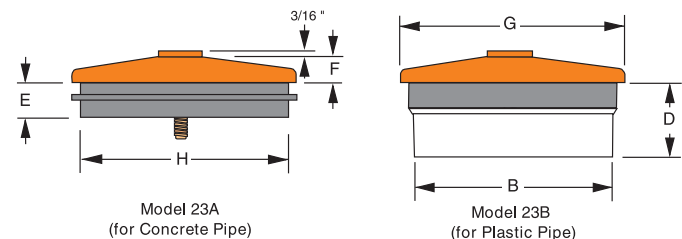
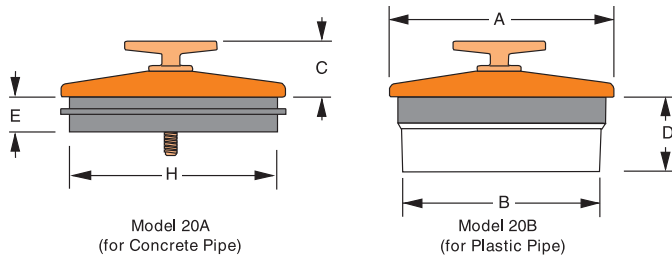

| Valve Size (Inches) | Model/Weight (lbs) | | | | Dimensions (Inches) | | | | | | | | Screw Thread | | | |
|---------------------|--------------------|------|------|------|---------------------|-------|------|------|------|------|-------|-------|--------------|-------|----------|------|
| | | | | | | | | | | | | | Standard | | Optional | |
| | 20A | 20B | 23A | 23B | A | B | C | D | E | F | G | H | Type | Dia. | Type | Dia. |
| 3 | 2.5 | - | - | - | 3.75 | - | 2.62 | - | 1.46 | - | - | 3.14 | VEE | 1/2 | N/A | N/A |
| 3-1/2 | 3.3 | - | 3.0 | - | 4.34 | - | 2.69 | - | 1.62 | 0.91 | 4.25 | 3.80 | VEE | 1/2 | N/A | N/A |
| 4 | 3.3 | 3.8 | - | - | 4.81 | 4.21 | 2.69 | 2.15 | 1.71 | - | - | 4.19 | VEE | 1/2 | N/A | N/A |
| 5 | 4.3 | 5.8 | 4.5 | 5.8 | 5.81 | 5.88 | 2.38 | 2.88 | 1.78 | 1.00 | 5.81 | 5.16 | VEE | 1/2 | N/A | N/A |
| 6 | 7.8 | 9.8 | 8.5 | 10.8 | 6.88 | 5.88 | 2.44 | 4.47 | 2.03 | 1.28 | 6.94 | 6.26 | ACME | 3/4 | VEE | 5/8 |
| 6-1/2 | 8.3 | - | 8.5 | - | 7.53 | - | 3.12 | - | 2.04 | 1.25 | 7.75 | 6.94 | VEE | 5/8 | N/A | N/A |
| 8 | 12.0 | 15.5 | 12.3 | 15.8 | 9.38 | 7.94 | 2.56 | 4.44 | 2.00 | 1.44 | 9.25 | 8.68 | ACME | 3/4 | VEE | 5/8 |
| 10 | 18.3 | 25.5 | 18.0 | 25.3 | 10.94 | 9.88 | 2.81 | 5.53 | 2.00 | 1.94 | 10.88 | 10.36 | ACME | 29/32 | VEE | 3/4 |
| 12 | 22.0 | 28.0 | 22.8 | 30.0 | 13.03 | 11.81 | 3.06 | 4.94 | 2.00 | - | 13.12 | 12.38 | ACME | 29/32 | VEE | 3/4 |
| 14 | 27.5 | 32.0 | 32.0 | - | 15.25 | 14.88 | 3.12 | 4.44 | 2.12 | - | - | 14.44 | ACME | 29/32 | VEE | 3/4 |
| 16 | 47.0 | - | - | - | 17.25 | - | 3.81 | - | 2.34 | - | 16.44 | 16.44 | ACME | 1-1/8 | N/A | N/A |
| 18 | 51.0 | 66.0 | 66.0 | - | 19.44 | 17.88 | 3.59 | 5.75 | 2.44 | - | 18.75 | 18.69 | ACME | 1-1/8 | N/A | N/A |
| 20 | 73.5 | 96.0 | 96.0 | - | 21.44 | 19.88 | 3.69 | 6.75 | 2.78 | - | 20.85 | 20.81 | ACME | 1-1/8 | N/A | N/A |



Fresno Valves & Castings, Inc.

7736 East Springfield Avenue
P.O. Box 40, Selma, CA 93662, U.S.A.

(800) 333-1658

www.fresnovalves.com